

# 19TH ANNUAL CONFERENCE



# ISPN 2017

On behalf of the ISPN Board and members of the conference planning committee, we are pleased to welcome you to *The Future of Mental Health. Connect. Collaborate. Differentiate*, the 19th Annual Conference of the International Society of Psychiatric-Mental Health Nurses (ISPN) in Baltimore, MD. The mental health needs of individuals across the life span continue to be a major public health concern in America and around the globe. The focus of our annual conference is to address these concerns and to lead the way forward in developing solutions that truly impact the lives of persons diagnosed with a mental disorder. These solutions include *Connecting* and *Collaborating* with other health care providers while *Differentiating* the unique role of psychiatric-mental health nurses within this specialty service.

We thank our expert presenters and panelists who share their perspectives on mental health. We'll hear from international speakers about global news, clinical experts about innovative practices and advocacy, educators about new teaching pedagogies and interprofessional collaboration, and researchers about evidence-based findings across the spectrum of psychiatric interests and mental health disorders.

Special thanks to the planning committee for their commitment and dedication to ensuring a stellar conference experience, our ISPN colleagues, and The Rees Group, who have worked diligently throughout the past year to plan and offer a state-of-the-art conference. Thanks as well to all of the sponsors who made this event possible and for believing in the importance of promoting psychiatric-mental health across the lifespan and around the globe.

We are delighted that you have joined this unique audience—a gathering of psychiatric-mental health nurses from academe, practice, research, and administration. Your participation and input, and more importantly, your resolve to address mental health issues that impact the lives of so many is inspiring and appreciated. Thank you for your commitment to “affecting change.”

*Carla Groh*

Carla J. Groh, PhD, PMHNP-BC, FAAN  
Chair

*Amanda Baltierra*

Amanda J. Baltierra, DNP, MPH, FNP-BC, PMHNP-BC  
Co-Chair

And the Conference Committee

March 8-11

Marriott Inner Harbor at

Camden Yards

Baltimore, Maryland

USA

## CONTENTS

Abstract Reviewers .....	2
Awards .....	5
Badges .....	5
Board & Leadership .....	4
Business Meeting .....	3
Call for 2018 Abstracts .....	5
Care Room.....	3
Conference Committee .....	2
Disclosures & COI Statements ...	5
Evaluation Form .....	3
Exhibitors .....	6
Hotel Business Center Info .....	3
Hotel Floor Plan.....	18
ISPN Foundation Event.....	3
Meeting Rooms.....	3
Message Center.....	3
New Member Orientation .....	3
New to 2017 Conference .....	3
Nursing Contact Hours.....	2
Objectives .....	2
Poster Session .....	14
Poster Viewing Hours .....	2
Program Schedule .....	8
Registration .....	2
Safety & Security.....	16
Save the Date: ISPN 2018.....	20
Speaker Ready Room .....	3
Sponsors .....	17
UPS Shipping Info.....	3
Volunteers.....	3

# GENERAL INFORMATION

On This Page  
Conference Committee  
Abstract Reviewers

Conference Objectives  
Nursing Contact Hours

Registration  
Poster Viewing Hours

<b>Conference Committee</b>	<p>Carla Groh, PhD, PMHNP-BC, FAAN-Chair Amanda J. Baltierra, DNP, MPH, FNP-BC, PMHNP-BC-Co-Chair Pamela Galehouse, PhD, RN, PMHCNS-BC, CNL Cynthia Taylor Handrup, DNP, APN, PMHCNS-BC Merrie J. Kaas, PhD, RN, PMHCNS-BC, FAAN Sukh Dev Singh Khalsa, DNP, MBA, MSN, RN, PMHNP-BC, PHN Heeyoung Lee, PhD, PMHNP-BC Barbara Peterson, PhD, PMHCNS-BC, RN</p>
<p><b>Abstract Reviewers</b></p> <p><i>Thanks to all of the individuals who served as abstract reviewers for this year's program. We appreciate your involvement!</i></p>	<p>Amanda Baltierra, DNP, MPH, FNP-BC, PMHNP-BC Carol Baxter, APN, PMHCNS-BC Lora Beebe, PhD, PMHNP-BC Linda Chafetz, PhD, RN Maureen Doyle, PhD, APRN Janine Graf-Kirk, DNP, MA, RN, BC, CNE Carla Groh, PhD, PMHNP-BC, FAAN Merrie Kaas, PhD, RN, PMHCNS, FAAN Susan Krupnick, MSN, PMHCNS-BC, ANP-BC, C-PREP Karan Kverno, PhD, PMHCNS-BC, PMHNP-BC Heeyoung Lee, PhD, PMHNP-BC Rene Love, PhD, DNP, PMHNP-BC, FNP, FAANP Jane Neese, PhD, APRN-BC Sandra Nelson, PhD, RN, CS Patricia Nisbet, DNP, PMHNP-BC Karen Ragaisis, DNP, APRN, PMHNP-BC, PMHCNS-BC, CARN Luann Richardson, PMHNP, FNP, DNP, PhD, Met S Margaret Scharf, DNP, PMHCNS-BC, FNP-BC, PMHNP Marilyn Shirk, MN, RN, CNS-BC Sheila Swales, MS, RN, PMHNP-BC Cynthia Taylor Handrup, DNP, APN, PMHCNS-BC Rose Mary Xavier, MS, RN, PMHNP-BC Jaclene Zauszinski, PhD, RN-BC, FAAN</p>
<b>Conference Objectives</b>	<p>Attendees will be able to:</p> <ol style="list-style-type: none"> <li>1. Advance psychiatric-mental health nursing through collaborative strategies with patients, families, colleagues, advocacy groups and other disciplines to promote the mental health and recovery of persons with mental disorders.</li> <li>2. Apply evidence-based quality improvement innovations into psychiatric-mental health nursing practice.</li> <li>3. Describe new research findings in neuroscience and how they may impact psychiatric mental health nursing practice.</li> <li>4. Identify innovative strategies that differentiate psychiatric mental health nurses from other behavioral health specialists.</li> </ol>

<b>Nursing Contact Hours</b>	<p>This continuing nursing education activity was approved by the Wisconsin Nurses Association Continuing Education Approval Program Committee, an accredited approver by the American Nurses Credentialing Center's Commission on Accreditation.</p> <p>The ISPN 2017 Annual Conference has been awarded a maximum of <b>15.72</b> continuing education nursing contact hours through the Wisconsin Nurses Association Continuing Education Approval Program Committee. Contact hours are complimentary with your registration fee.</p> <p>To obtain continuing education contact hours for attending the ISPN Annual Conference, please complete the attendance form included in your packet of materials and evaluation form that will be sent to you via email. Please turn in the attendance form to the ISPN Registration Desk before you leave the Conference.</p> <p>The attendance form will serve as your contact hour certificate.</p>										
<b>Registration</b>	<p>Conference registration is located on the 1st floor (Grand Ballroom Foyer) and is open as follows:</p> <table> <tr> <td>Tuesday, March 7</td><td>11:30 a.m.-5:00 p.m.</td></tr> <tr> <td>Wednesday, March 8</td><td>7:30 a.m.-7:00 p.m.</td></tr> <tr> <td>Thursday, March 9</td><td>7:30 a.m.-5:00 p.m.</td></tr> <tr> <td>Friday, March 10</td><td>7:30 a.m.-5:00 p.m.</td></tr> <tr> <td>Saturday, March 11</td><td>7:30 a.m.-1:00 p.m.</td></tr> </table>	Tuesday, March 7	11:30 a.m.-5:00 p.m.	Wednesday, March 8	7:30 a.m.-7:00 p.m.	Thursday, March 9	7:30 a.m.-5:00 p.m.	Friday, March 10	7:30 a.m.-5:00 p.m.	Saturday, March 11	7:30 a.m.-1:00 p.m.
Tuesday, March 7	11:30 a.m.-5:00 p.m.										
Wednesday, March 8	7:30 a.m.-7:00 p.m.										
Thursday, March 9	7:30 a.m.-5:00 p.m.										
Friday, March 10	7:30 a.m.-5:00 p.m.										
Saturday, March 11	7:30 a.m.-1:00 p.m.										
<b>Poster Presentation Viewing Hours</b>	<p>Posters will be available for viewing in Stadium Ballroom at the following times:</p> <table> <tr> <td>Wednesday, March 8</td><td>6:30 p.m.-8:00 p.m. (Opening Reception)</td></tr> <tr> <td>Thursday, March 9</td><td>7:30 a.m.-5:00 p.m.</td></tr> <tr> <td>Friday, March 10</td><td>7:00 a.m.-3:30 p.m.</td></tr> </table> <p>Poster presenters will be available at their poster during the Opening Reception on Wednesday, March 8, from 6:30 p.m.-8:00 p.m. They will also be present during each refreshment break on Thursday and Friday. Please be sure to schedule time to visit the poster session.</p>	Wednesday, March 8	6:30 p.m.-8:00 p.m. (Opening Reception)	Thursday, March 9	7:30 a.m.-5:00 p.m.	Friday, March 10	7:00 a.m.-3:30 p.m.				
Wednesday, March 8	6:30 p.m.-8:00 p.m. (Opening Reception)										
Thursday, March 9	7:30 a.m.-5:00 p.m.										
Friday, March 10	7:00 a.m.-3:30 p.m.										

# GENERAL INFORMATION

## On This Page

New to the 2017 Conference  
Care Room  
New Member Orientation

## Volunteers

Speaker Ready Room  
ISPN Foundation Event  
Evaluation Form

## Business Meeting

Message Center  
Meeting Rooms  
Hotel Business Center/UPS

<b>New to the 2017 Conference</b>	<p><b><u>Mobile App</u></b> ISPN has gone mobile! Download Guidebook and search for ISPN Conference. View the agenda, and plan your schedule from your phone or tablet.</p> <p><b><u>Morning Yoga</u></b> Thursday, March 9 • 6:00 a.m.-6:45 a.m. B&amp;O Railroad</p> <p><b><u>Product Theater Luncheon</u></b> <i>A Closer Look at a Long-Acting Injectable for Schizophrenia: A Patient-Focused Discussion</i> Thursday, March 9 • 12:10 p.m.-1:10 p.m. Grand Ballroom</p> <p><b><u>Special Interest Group Meetings</u></b> Friday, March 10 • 7:00 a.m. to 8:00 a.m.  <ul style="list-style-type: none"> <li>• Psychiatric Mental Health Policy – Promenade</li> <li>• Psychiatric Consultation-Liaison – University 3 &amp; 4</li> <li>• Advanced Nursing Practice – University 1 &amp; 2</li> </ul> </p> <p><b><u>Luncheon Symposium</u></b> <i>Clinical Convergence<sup>SM</sup>: Patient and Provider Perspectives on Optimal Care in Bipolar Depression</i> Friday, March 10 • 11:10 a.m.-12:55 p.m.</p> <p><b><u>University of Maryland School of Nursing Tour</u></b> Friday, March 10 • 7:00 p.m.-9:00 p.m. (Limited availability)</p>
<b>Care Room</b>	Drop by for respite in the ISPN Care Room hosted by Sara Horton-Deutsch in the B&O Railroad Room (2nd Floor).
<b>New Member and Student Breakfast</b>	<p>Thursday, March 9 7:30 a.m.-8:30 a.m. • Harbor 2</p> <p>Calling all new members, first-time conference attendees, students, and individuals considering becoming a member! This is the perfect opportunity to ask questions and meet the ISPN Board of Directors. Please join us!</p>
<b>Volunteers</b>	We are always looking for members to volunteer on committees, task forces, as abstract reviewers, and room monitors. Send an email to <a href="mailto:info@ispn-psych.org">info@ispn-psych.org</a> , leave your name at the ISPN registration desk, or complete the volunteer form in your materials bag.
<b>Speaker Ready Room</b>	<p>The Speaker Ready Room will be open during the following hours in Harbor 1. Please stop by to preview your presentation prior to your session.</p> <p>Wednesday, March 8 11:00 a.m.-5:00 p.m. Thursday, March 9 7:00 a.m.-5:00 p.m. Friday, March 10 7:00 a.m.-5:00 p.m. Saturday, March 11 7:00 a.m.-10:00 a.m.</p>

<b>ISPN Foundation Reception and Auction</b>	<p>The annual ISPN Foundation Reception and Auction features heavy hors d'oeuvres, a drink ticket, live and silent auction, and networking with colleagues in the mental health community. Proceeds fund research, wellness, and travel grants.</p> <p>This year's theme is "Take Me Out to the Ball Park," so wear your favorite team's logowear and join the fun on Thursday, March 9, 2017, 6:15 p.m.-8:15 p.m., at the Grand Ballroom West in the Baltimore Marriott Inner Harbor at Camden Yards. Pre-ordered tickets will be distributed at registration, where you also can check for ticket availability.</p>
<b>Evaluation Form</b>	The program evaluation form will be emailed to your email address on file. Please complete and submit your evaluation form electronically. Your comments are valuable to the ISPN and assist the Conference Committee in planning future conferences.
<b>Business Meeting</b>	ISPN will hold its Annual Business Meeting on Saturday, March 11 starting at 7:15 a.m. in Grand Ballroom. All members are encouraged to join the Board of ISPN to discuss the Society's business report. Please be sure to attend!
<b>Message Center</b>	All messages for registrants will be posted on the Announcement Board in the ISPN Registration Area. Check this board each day so you don't miss a contact in Baltimore or a message from the office!
<b>Meeting Rooms</b>	Audible signals from pagers and cellular phones may be a distraction to the speaker as well as the audience. Please program these accordingly and take phone calls outside of the meeting rooms. Thank you!
<b>Hotel Business Center</b>	The hotel offers a self-service business center on the 2nd floor of the hotel. It is open 24-hours and is accessible with hotel key-card.
<b>UPS Ship Center</b>	<p>The UPS Store operates the Shipping &amp; Receiving department for the Baltimore Marriott Inner Harbor at Camden Yards. It handles all arriving and departing shipments for guests, groups, events, exhibitors, and contractors.</p> <p>Monday-Friday: 9:00 a.m.-5:00 p.m. Nights, Saturday, Sunday: By prior arrangement</p>

# GENERAL INFORMATION

## On This Page

### Board of Directors and Leadership

<b>Board of Directors and Leadership</b>	
<b>Officers and Directors</b>	<p><b>President</b> Edilma L. Yearwood, PhD, PMHCNS, BC, FAAN</p> <p><b>President-Elect</b> Rene Love, PhD, DNP, PMHNP-BC, FNAP, FAANP</p> <p><b>Treasurer</b> Margaret Plunkett, APRN, MSN, PMHCNS-BC</p> <p><b>Past President</b> Elizabeth Bonham, PhD, RN, PMHCNS-BC</p> <p><b>Directors</b> Andrea Kwasky, DNP, PMHNP-BC, PMHCNS-BC</p> <p>Steven Pryjmachuk, PhD, PGDipEd, RN (Mental Health), CPsychol, SFHEA</p> <p>Sally Raphael, MS, APRN/PMH, FAAN</p>
<b>Recording Secretary</b>	Rhonda Schwindt, DNP, RN, PMHCNS-BC, PMHNP
<b>ISPN Foundation Board</b>	<p><b>President</b> Linda Skalsky, MSN, APRN, PMH-BC</p> <p><b>Secretary</b> Caroline McKinnon, PhD, PMHCNS-BC</p> <p><b>Treasurer</b> Judy Fry-McComish, PhD, RN, FAAN</p> <p><b>Directors</b> Peggy Dulaney, MSN, RN Janice Goodman, PhD, PMHCNS-BC Jim Kane, MN, RN, CNS, NEA-BC Irene Kim, DNP, PMHNP-BC, PMHCNS-BC Evelyn Parrish, PhD, APRN-BC Sandra Wood, MSN, APRN, BC</p>
<b>ISPN Executive Director</b>	Kathy Kuehn

<b>Board of Directors and Leadership</b>	
<b>Committees</b>	<p><b>Awards Committee Chair</b> Ukamaka M. Oruche, PhD, RN, PMHCNS-BC</p> <p><b>Communications Committee</b> Andrea Kwasky, DNP, PMHNP-BC, PMHCNS-BC, Co-Chair</p> <p>Steven Pryjmachuk, PhD, PGDipEd, RN (Mental Health), CPsychol, SFHEA, Co-Chair</p> <p><b>Conference Committee Chair</b> Carla J. Groh, PhD, PMHNP-BC, FAAN</p> <p>Amanda Baltierra, DNP, MPH, FNP-BC, PMHNP-BC, Co-Chair</p> <p><b>Psychopharmacology Institute Planning Committee</b> Karen Ragaisis, DNP, APRN, PMHNP-BC, PMHCNS-BC, CARN, Co-Chair</p> <p>Susan Krupnick, MSN, PMHCNS-BC, ANP-BC, C-PREP, Co-Chair</p> <p><b>Diversity and Equity Committee Chair</b> Cheryl Woods-Giscombe, PhD, PMHNP-BC</p> <p><b>Finance Committee Chair</b> Margaret Plunkett, APRN, MSN, PMHCNS-BC</p> <p><b>Marketing and Development Committee Chair</b> Caroline McKinnon, PhD, CNS/PMH-BC</p> <p><b>Membership Committee Chair</b> Kathleen McCoy, DNSc, APRN, PMHNP, CNS-BC, FAANP</p> <p><b>Nominating Committee Chair</b> Elizabeth Bonham, PhD, RN, PMHCNS-BC, ISPN Past President</p> <p><b>Website Management Committee Chair</b> Kristina Stevens, MSN, PMH-APN, BC</p> <p>Cynthia Taylor Handrup, DNP, APN, PMHCNS-BC, Co-Chair</p>
<b>Newsletter Editor</b>	Angela McNelis, PhD, RN, ANEF

# GENERAL INFORMATION

## On This Page

Awards  
Internet  
Badges  
Call for Abstracts

## Disclosures Purpose Statement

## Notice of Requirement for Successful Completion

## Conflict of Interest

## Non-Endorsement of Products

<b>Awards</b>	ISPN will present its annual awards on Saturday, March 11, 7:45 a.m. in the Grand Ballroom. Please join your friends and colleagues in recognizing those who have demonstrated outstanding achievement and leadership in the psychiatric and mental health field.
<b>Internet</b>	Complimentary basic high-speed wireless Internet is available in the meeting rooms for ISPN Annual Conference attendees. The Marriott does have complimentary wireless Internet in the lobby and public areas. Guest room wireless fees apply.
<b>Badges</b>	Your badge will admit you to all the educational sessions and the exhibit area at the Annual Conference. It is recommended that you wear your badge at all times during the conference. Please remove your badge when you leave the hotel.
<b>2018 Annual Conference Call for Abstracts</b>	The ISPN 2018 Call for Abstracts deadline is July 1, 2017. Abstracts for the 2018 Conference can be submitted through an online submission form that will be located on the ISPN website ( <a href="http://www.ispn-psych.org">www.ispn-psych.org</a> ). More information will be posted on the website in May 2017.
<b>Disclosures Purpose Statement</b>	Participants will be able to incorporate into their own practices the research and best practices learned from clinical experts about innovative practices and advocacy, from educators about new teaching pedagogies and interprofessional collaboration, and from researchers about evidence-based findings across a spectrum of psychiatric interests and mental health disorders across the lifespan and around the globe.
<b>Notice of Requirement for Successful Completion</b>	To obtain continuing education contact hours for attending the ISPN Psychopharmacology Institute and Annual Conference, you must attend all sessions you are seeking credit for, complete and submit the attendance form included in your packet of materials, and complete and submit the evaluation form that will be sent to you via email. Please turn in the attendance form to the ISPN Registration Desk before you leave the Conference. The attendance form will serve as your contact hour certificate.

<b>Conflict of Interest</b>	<p>Psychopharmacology Institute &amp; ISPN Annual Conference March 7-11, 2017</p> <p>The Wisconsin Nurses Association Continuing Education Approval Program requires that any speaker giving a presentation must disclose any significant financial interest or other relationship that they may have with the manufacturer(s) of any commercial products, service, technology, or program discussed at their educational presentation.</p> <p>The Wisconsin Nurses Association Continuing Education Approval Program does not imply that any such financial interest or relationship is inherently improper or that such interest or relationship would prevent the speaker from making a presentation. It is imperative, however, that such financial interests or relationships be identified by the speaker so that participants have these facts fully disclosed prior to the presentation and may form their own judgments about the presentation.</p> <p>Below is a listing of speakers who have reported having relationships with commercial companies.</p> <p>Deborah Gross Rush University</p> <p>Jim Kane The Advisory Board Company</p> <p>Vicki Hines-Martin Routledge Publishing Company</p> <p>Evelyn Parrish PsychU</p> <p>Deborah Sandella The RIM Institute</p> <p>Diane Snow Sunovion Pharmaceuticals Otsuka Pharmaceuticals</p> <p>Deborah Thomas Assurex Health Sunovion Pharmaceuticals</p> <p>Linda Jo Volness Assurex Health</p> <p>The remaining speakers have reported no relationships with commercial companies.</p>
<b>Non-Endorsement of Products</b>	The presence of commercial exhibits during the conference does not imply endorsement by the ISPN, Wisconsin Nurses Association, or the American Nurses Credentialing Center's Commission on Accreditation.

# EXHIBITORS

The exhibit area will be located in the Stadium Ballroom (Level 2) . It will also be the site of the poster sessions and refreshment breaks during the Conference. Please plan time to stop by and visit with the exhibiting companies, which lend valuable financial support to the ISPN Conference.

Don't forget to complete and submit your Exhibitor Sign-Off sheet, found in your materials bag. You will be eligible to win a prize, brought to you by the Marketing and Development Committee.

## Open Hours:

Wednesday, March 8	6:30 p.m.-8:00 p.m.
Thursday, March 9	7:30 a.m.-5:00 p.m.
Friday, March 10	7:00 a.m.-3:30 p.m.

Exhibitor	Booth
<b>ACADIA Pharmaceuticals, Inc.</b>	<b>6</b>

3611 Valley Centre Drive, Suite 300  
San Diego, CA 92130  
Tel: 858-558-2871  
Fax: 858-558-2872

At ACADIA, we are passionate about improving the lives of patients with central nervous system (CNS) disorders. We are building the foundation to become a leading biopharmaceutical company dedicated to developing and commercializing innovative therapies in the CNS area.

Exhibitor	Booth
<b>Alkermes</b>	<b>12</b>

852 Winter Street  
Waltham, MA 02451-1420  
Phone: 781-609-6000  
Email: USMedInfo@alkermes.com  
Website: www.Alkermes.com

Alkermes is a fully integrated biopharmaceutical company that applies its scientific expertise and technological know-how to develop innovative medicines designed to help patients with serious, chronic conditions better manage their disease. For more information, please visit Alkermes' website at [www.alkermes.com](http://www.alkermes.com).

Exhibitor	Booth
<b>Diamond Healthcare Corporation</b>	<b>9</b>

P.O. Box 85050  
Richmond, VA 23285  
Telephone: 804-649-9340  
Fax: 804-782-2286  
[www.diamondhealth.com](http://www.diamondhealth.com)

Celebrating our 32nd year, Diamond Healthcare is a fully integrated population health management organization with a special emphasis on behavioral health. We own or operate over 80 Psychiatric programs in 31 states across the country. For career information, please visit us at [www.diamondhealth.com](http://www.diamondhealth.com).

Exhibitor	Booth
<b>Johns Hopkins School of Nursing</b>	<b>7</b>

525 N. Wolf Street  
Baltimore, MD 21146  
Website: [www.nursing.jhu.edu](http://www.nursing.jhu.edu)

The Johns Hopkins School of Nursing, a globally recognized leader in education, research and practice, ranks #1 among graduate schools of nursing (U.S. News & World Report) and #1 for Federal Research Grants and National Institutes of Health funding. Visit [nursing.jhu.edu](http://nursing.jhu.edu).

Exhibitor	Booth
<b>MHM Services Inc.</b>	<b>15</b>

1593 Springhill Rd.  
Vienna, VA 22182  
Phone: 571-281-2284  
Email: [carac@mhmcareers.com](mailto:carac@mhmcareers.com)  
Website: [www.mhm-services.com](http://www.mhm-services.com)

MHM Services, Inc. is a leading provider of healthcare services to state and local governments nationwide. MHM boasts over 30 years of experience in providing contractual medical and mental health management services in a wide range of settings including state hospitals, correctional facilities, and other community mental health centers. MHM currently employs over 6,000 healthcare professionals across 15 states. As we continue to grow, we are always looking for dedicated healthcare professionals to join our team.

Exhibitor	Booth
<b>Otsuka America Pharmaceutical, Inc. &amp; Lundbeck</b>	<b>8</b>

508 Carnegie Center Drive  
Princeton, NJ 08540  
Phone: 609-524-6788  
Email: [contact@otsuka-us.com](mailto:contact@otsuka-us.com)  
Website: <https://www.otsuka-us.com>

## OAPI

Otsuka America Pharmaceutical, Inc. (OAPI), part of the Otsuka Group, is a fast-growing, innovative company with 25 years of experience in commercializing products developed by Otsuka, as well as in licensed products, focusing on a diverse portfolio of products in neuroscience, oncology and cardio-renal. For more information, visit us at <https://www.otsuka-us.com>

## Lundbeck

Lundbeck is a global pharmaceutical company, specialized in psychiatric and neurological disorders. In the U.S., Lundbeck focuses solely on accelerating therapies for brain disorders, including epilepsy and actively engages in hundreds of initiatives each year that support our patient communities. For more information, visit us at <http://www.lundbeck.com/us>

Exhibitor	Booth
<b>PsychU</b>	<b>13</b>

163 York Street  
Gettysburg, PA 17325  
Phone: 855-559-6829  
Email: [info@psychu.org](mailto:info@psychu.org)

PsychU's free community and resource library is focused on the changing needs of the behavioral health professional. The PsychU community of over 21,000+ members brings together all professionals involved in providing, financing, or regulating mental health services.

Exhibitor	Booth
<b>Sunovion Pharmaceuticals, Inc.</b>	<b>14</b>

84 Waterford Drive  
Marlborough, MA 01752  
508-481-6700

Sunovion Pharmaceuticals Inc., is a leading pharmaceutical company dedicated to discovering, developing, and commercializing therapeutic products that advance the science of medicine in the central nervous system and respiratory disease areas to improve the lives of patients and their families. Visit us online at [www.sunovion.com](http://www.sunovion.com).

# EXHIBITORS

Exhibitor	Booth	Exhibitor	Booth
<b>Takeda Pharmaceuticals</b>	<b>4</b>	<b>Taylor &amp; Francis</b>	<b>5</b>
One Takeda Parkway Deerfield, IL 60015 Phone: 224-554-6500  Striving toward better health for people worldwide through leading innovation in medicine.		530 Walnut Street, Suite 850 Philadelphia, PA 19106 Phone: 215-625-8900 Fax: 215-606-0050 Website: <a href="http://www.tandfonline.com">www.tandfonline.com</a>  Taylor & Francis is a leading international publisher of scholarly research. We are proud to publish issues in Mental Health Nursing as a part of our medical portfolio of journals. Visit our booth to learn more about our products and services and to pick up free copies of our journals.	

**ISPN would like to thank  
its 2017 Annual Conference Exhibitors!**

**Sunovion Pharmaceuticals Inc.  
is dedicated to developing new  
treatment options for patients  
and their families living with  
mental illness.**



SUNOVION and the flower icon are registered trademarks of Sumitomo Dainippon Pharma Co., Ltd.  
Sunovion Pharmaceuticals Inc. is a U.S. subsidiary of Sumitomo Dainippon Pharma Co., Ltd.  
© 2015 Sunovion Pharmaceuticals Inc. All rights reserved. LAT364-15 3/16

# WEDNESDAY/THURSDAY

## Program Schedule / March 8 & 9

### Wednesday, March 8

6:30 p.m.-8:00 p.m.

Stadium Ballroom

#### Opening Reception and Poster Session

### Thursday, March 9

6:00 a.m.-6:45 a.m.

B&O Railroad

#### Morning Yoga

Kandy Aboud, MSN, PMHNP-BC, PMHCNS-BC

7:00 a.m.-8:30 a.m.

Harbor 2

#### ISPN New Member Orientation and Student Breakfast

7:30 a.m.-8:30 a.m.

Stadium Ballroom

#### Continental Breakfast and Exhibits

7:30 a.m.-8:30 a.m.

Orioles Boardroom

#### ISPN Foundation Board Meeting

8:30 a.m.-8:45 a.m.

Grand Ballroom

#### Welcome



8:45 a.m.-9:45 a.m.

Grand Ballroom

#### Opening Keynote Address

*The Future of Mental Health Begins in Early Childhood: Implications for Practice, Research, and Policy*

Deborah Gross, DNSc, RN, FAAN

*Funding for this presentation is possible, in part, through funds generously donated to the ISPN Foundation.*

10:00 a.m.-10:50 a.m.

#### Concurrent Session 1

University 1-2

#### Concurrent Session 1.1

*Working Together: Integrated Psychiatric-Mental Health and Primary Care Simulation in a DNP Program*

Cynthia Taylor Handrup, DNP, APN, PMHCNS-BC

Marsha Snyder, PhD, PMHNP/CNS-BC

Ruth A. Woroch, DNP, FNP-BC

University 3-4

#### Concurrent Session 1.2

*Evidenced-Based Prescribing Practices in Treating Post-Traumatic Stress Disorder in Combat Veterans*

Ret. Lt. Colonel Jess Calohan, DNP, PMHNP-BC, LTC

Promenade

#### Concurrent Session 1.3

*The Use of Pharmacogenomics in the Clinical Setting: Insights, Trends, and Considerations*

Joanna Johnson, MSN, PMHNP-BC

LEARN MORE ABOUT AN IMPORTANT TOPIC IN PSYCHIATRIC CARE: ATTEND OUR PRODUCT THEATER AT THE 2017 ISPN 10TH ANNUAL PSYCHOPHARMACOLOGY INSTITUTE AND 19TH ANNUAL CONFERENCE!

A Closer Look at a Long-Acting Injectable for Schizophrenia:  
A Patient-Focused Discussion

Thursday, March 9, 2017

#### LOCATION

Baltimore Marriott Inner Harbor  
at Camden Yards  
Grand Ballroom East & West  
110 S. Eutaw Street  
Baltimore, Maryland 21201

#### FEATURED FACULTY

Laura K. Melaro, DNP, APRN,  
FNP-BC, FPMHNP-BC  
Family/Psychiatric Mental Health  
Nurse Practitioner and Consultant,  
Integrated Behavioral Health Program  
Bolivar, Tennessee

#### AGENDA

12:00PM EST | Registration  
12:10PM EST | Presentation  
1:00PM EST | Q&A Session

Dr. Melaro is a paid consultant for Otsuka America Pharmaceutical, Inc. and Lundbeck.

The intended audience for this program is healthcare professionals involved in the treatment of patients with schizophrenia.

This program is sponsored by Otsuka America Pharmaceutical, Inc. (Otsuka) and Lundbeck and is not a CME activity.

In accordance with the PhRMA Code on Interactions with Healthcare Professionals, attendance at this educational program is limited to only Healthcare Professionals (Physicians, Nurse Practitioners, Physician Assistants, RNs, Clinical Pharmacists, Social Workers). Accordingly, attendance by guests or spouses is not permitted.

This is a promotional program and no CME credits are offered. This educational program may include the provision of a modest meal. Otsuka and Lundbeck do not offer such a meal to healthcare professionals (HCPs) whose institutions prohibit such hospitality, nor do Otsuka and Lundbeck offer a meal where federal or state laws (e.g., Vermont and Minnesota) limit an HCP's ability to accept such a meal. Accordingly, please consult your legal or ethics advisor regarding any applicable limitation before attending this educational program. If you are licensed to practice in a state where meals are either prohibited and/or restricted and you accept a meal, you understand that you will be required to reimburse Otsuka for the cost of this meal.

Please note that Otsuka and Lundbeck are required to report the value of a provided meal pursuant to applicable federal and/or state laws.

This invitation is non-transferable.

Model is used for illustrative purposes only.

© 2017 Otsuka America Pharmaceutical, Inc., Rockville, MD.  
All rights reserved. January 2017 09US17EUP0002



### Chesapeake

#### Concurrent Session 1.4

*Understanding Self-Injury in Persons With Autism Spectrum Disorder*

Judith Coucouvanis, MA, APRN-BC, PMHCNS-BC

### Grand Ballroom DEF

#### Concurrent Session 1.5

*The Most Prevalent Psychiatric Diagnosis That Nobody Talks About in the Hospital: Delirium*

Alan Amberg, MSN, APN, PMHNP

10:50 a.m.-11:20 a.m.

### Stadium Ballroom

#### Refreshment Break

#### Exhibits and Poster Session

11:20 a.m.-12:10 p.m.

#### Concurrent Session 2

### University 1-2

#### Concurrent Session 2.1

*Promoting Resilience in Children With Traumatic Life Experiences in the Context of Family and Community Resilience*

Irene Kim, DNP, NPP, PMHNP-BC, PMHCNS-BC

*An Innovative Program to Increase the Proportion of Children/Teens With Mental Health Problems Who Receive Treatment*

Mark Soucy, PhD, RN, PMHCNS, PMHNP, FAANP

Gail Williams, PhD, PMHCNS-BC

### University 3-4

#### Concurrent Session 2.2

*Leadership, Partnership, and Nursing: Lessons Learned From the Global Mental Health Nursing Project*

Vicki Hines-Martin, PhD, CNS, RN, FAAN

Edilma Yearwood, PhD, PMHCNS-BC, FAAN

*A Qualitative Exploration of Nurses' Experience With Suicide in Guyana*

Carla Groh, PhD, PMHNP-BC, FAAN

### Promenade

#### Concurrent Session 2.3

*Answer the Call: Mental Health Liaison Connects and Collaborates to Care for Providers Across the Organization*

Marilyn Shirk, MN, RN, CNS-BC

*Inpatient Psychiatry Readmission Reduction Project Overview*

Priscilla Adams, MSN, APRN-CNS

### Chesapeake

#### Concurrent Session 2.4

*Mind-Body-Spiritually Integrated Intervention for Female Veterans With Post-Traumatic Stress Disorder: A Randomized Pilot Study*

Jill Bormann, PhD, RN, FAAN

### Grand Ballroom DEF

#### Concurrent Session 2.5

*Using the Health Disparities on Outcomes (HDO) Model to Evaluate Population Health Outcomes in the Severely Mentally Ill*

Emily J. Hauenstein, PhD, LCP, MSN, FAAN

12:10 p.m.-1:10 p.m.

### Grand Ballroom

#### Product Theater Luncheon

*A Closer Look at a Long-Acting Injectable for Schizophrenia: A Patient-Focused Discussion*

Laura K. Melaro, DNP, APRN, FNP-BC, FPMHNP-BC

Sponsored by Otsuka America Pharmaceutical & Lundbeck



1:15 p.m.-2:05 p.m.

### Grand Ballroom

#### Diversity Keynote Address

*Shaping the Future of Diversity and Equity in Mental Health Care: Excellence in Research, Practice, Public Policy, and Leadership, Within Local and Global Communities*

Freida Outlaw, PhD, MSN, RN, FAAN

2:10 p.m.-3:40 p.m.

#### Workshop 3

### University 3-4

#### Workshop 3.2

*The Cost of Caring: The Impact and Management of Compassion Fatigue*

Mary Bemker, PhD, PsyS, MSN, LADC, LPCC-RN, CCFP

Mary Biddle, DNP, RN, CNE, CCFP

### Promenade

#### Workshop 3.3

*Perinatal Mental Health: A Practical Perspective on Medication Treatment*

Lyons Hardy, CNS, NP

### Chesapeake

#### Workshop 3.4

*Hearing Voices: A Six Second, Low Fidelity Simulation*

Brenda Marshall, EdD, APRN, ANEF

3:45 p.m.-4:30 p.m.

### Stadium Ballroom

#### Refreshment Break

#### Exhibits and Poster Session

#### International Meet & Greet

4:30 p.m.-6:00 p.m.

#### Symposium 4

### University 1-2

#### Symposium 4.1

*Understanding Best Practices in Mental Health Care for the Lesbian, Transgender, Bisexual, Transgender/Queer/Questioning Community: A Symposium and Panel Presented by the ISPN Diversity & Equity Committee*

Cheryl Giscombe, PhD, RN, PMHNP-BC

Elyse Pine-Twaddell, MD

Theodora Sirota, PhD, RN, CNL, PMHCNS-BC

# THURSDAY/FRIDAY

## Program Schedule / March 9 & 10

4:30 p.m.-6:00 p.m.

### **Workshop 4**

University 3-4

#### **Workshop 4.2**

*Alcohol SBI: A Skill-Building Workshop*

Ann Mitchell, PhD, RN, FAAN

Holly Hagle, PhD

Promenade

#### **Workshop 4.3**

*Collaborating to Effectively Lead Change*

Jim Kane, MN, RN, CNS, NEA-BC

Chesapeake

#### **Workshop 4.4**

*PCLN in Psychiatric Home Care: Development, Implementation, and Management of Psychiatric Home Care Services*

Susan Krupnick, MSN, PMHCNS-BC, ANP-BC, C-PREP

Judith Walters, DNP, RN

Frieda Vandegaer, PMH-CNS, BC

Grand Ballroom DEF

#### **Workshop 4.5**

*Using the Intelligible Steps of Bioethical Decision Making Model in Nursing to Make Competent and Confident Ethical Decisions in any Ethical Dilemma*

Kimberly Wolf, PHD, PMHCNS-BC

6:15 p.m.-8:15 p.m.

Grand Ballroom West

### **ISPN Foundation Reception**

(Available at an additional fee)

## Friday, March 10

7:00 a.m.-8:00 a.m.

Stadium Ballroom

### **Continental Breakfast in the Exhibit Hall**

#### **ISPN Special Interest Group Meetings**

University 1-2

##### **SIG for APN Formation**

University 3-4

##### **SIG for Psychiatric Consultation-Liaison Advanced Nursing Practice**

Promenade

##### **SIG for Psychiatric-Mental Health Policy**



8:00 a.m.-9:00 a.m.

Grand Ballroom

#### **Melva Jo Hendrix Lectureship**

*Professional Socialization of Psychiatric Mental Health Nurse Practitioner Students in an Online Program: Can This Be Achieved?*

Evelyn Parrish, PhD, PMHNP-BC

*Funding for this presentation is possible, in part, through funds generously donated to the ISPN Foundation.*



9:10 a.m.-10:00 a.m.

Grand Ballroom

#### **Invited Author**

*"The Good Nurse: A True Story of Medicine, Madness, and Murder." Lessons for Nurses From the Most Prolific Serial Killer in American History*

Charles Graeber

*Funding for this presentation is possible, in part, through funds generously donated to the ISPN Foundation.*

10:10 a.m.-10:20 a.m.

Stadium Ballroom

#### **Refreshment Break**

#### **Exhibits and Poster Session**

10:20 a.m.-11:10 a.m.

#### **Concurrent Session 5**

University 1-2

##### **Concurrent Session 5.1**

*Three Cohorts of RIDers: Program Improvements, Student Responses, and the Team Development Measure*

Lora Beebe, PhD, PMHNP-BC

Marian W. Roman, PhD, MSN, PMHCNS-BC

University 3-4

##### **Concurrent Session 5.2**

*Coming Out of the Shadows: Serious Mental Illness and Nursing Practice*

Ann Roselle, MSN, ACNP-BC

Promenade

##### **Concurrent Session 5.3**

*The IMIN Project: An Intentional Collaboration to Enhance Mental Health Care Practice*

Elizabeth Bonham, PhD, RN, PMHCNS-BC

Amanda Baltierra, DNP, MPH, FNP-BC, PMHNP-BC

Chesapeake

##### **Concurrent Session 5.4**

*Resourcefulness Training for Women Dementia Caregivers: Evaluation of Intervention Parameters*

Jaclene Zauszniewski, PhD, RN-BC, FAAN

Grand Ballroom DEF

##### **Concurrent Session 5.5**

*Suicide: Global and National Trends*

Carla Groh, PhD, PMHNP-BC, FAAN

11:10 a.m.-12:55 p.m.

Grand Ballroom

#### **Luncheon Symposium**

*Clinical Convergence<sup>SM</sup> Patient and Provider Perspectives on Optimal Care in Bipolar Depression*

Supported by an educational grant from Sunovion Pharmaceuticals Inc.



1:05 p.m.-2:00 p.m.

*Grand Ballroom*

### **International Foundation Speaker and Recognition of International Attendees**

*Mental Health Nursing, Social Inequities, and Partnerships With Consumers*

Brenda Happell, RN, RPN, BA(Hons), B Ed, M Ed, PhD

*Funding for this presentation is possible, in part, through funds generously donated to the ISPN Foundation.*

2:10 p.m.-3:00 p.m.

### **Concurrent Session 6**

*University 1-2*

#### **Concurrent Session 6.1**

*Reducing Harm Through Opioid Education in Prevention, Recognition, and Response*

Nancy Goldstein, DNP, MS, ANP-BC, CRNP

Karen Kaverno, PhD, PMHCNS-BC, PMHNP-BC

*Stories of Neonatal Abstinence: Mothers and Nurses*

Kelly Carlson, PhD, APRN-BC

*University 3-4*

#### **Concurrent Session 6.2**

*Social Media Interactive Demonstration*

Andrea Kwasky, DNP, PMHNP-BC, PMHCNS-BC

Steven Prymachuk, PhD, PGDipEd, RN (Mental Health), CPsychol, SFHEA

*Promenade*

#### **Concurrent Session 6.3**

*Manifestations of Trauma Across the Life Span: A Case Based Approach*

Elizabeth Bonham, PhD, RN, PMHCNS-BC

Evelyn Parrish, PhD, PMHNP-BC

*Homicide Bereavement: More Than Just Complicated Grief*

Judith Walters, DNP, RN, PMHCNS-BC

*Chesapeake*

#### **Concurrent Session 6.4**

*Promoting Community Involvement and Recovery for Individuals With Mental Health Conditions*

Helen Buckland, PhD, MEd

*Grand Ballroom DEF*

#### **Concurrent Session 6.5**

*Panel Presentation: Incorporating the 4th "P" into Psychiatric Mental Health Nursing Practice*

Marian Newton, PhD, PMHNP, PMHCNS, ANEF

Marsha J. Snyder, PhD, PMHNP/CNS-BC

Jo Annalee Irving, MS, ANRP, CS

Julie Carbray, PhD, PMHNP/CNS-BC

Cynthia Taylor Handrup, DNP, APN, PMHCNS-BC

Jo Snider, EdD, RN

3:00 p.m.-3:30 p.m.

*Stadium Ballroom*

### **Refreshment Break Exhibits/Posters**

3:30 p.m.-6:30 p.m.

### **Symposium 7**

*Grand Ballroom*

#### **Symposium 7.1**

*Child/Adolescent Psychiatric Mental Health Nursing Symposium*

*Depression, Anxiety, and Youth: Best Practices From Assessment to Treatment*

Andrea Kwasky, DNP, PMHNP-BC, PMHCNS-BC

Elizabeth Bonham, PhD, RN, PMHCNS-BC

Victoria Soltis-Jarrett, PhD, PMHCNS/NP-BC, FAANP

Debbie Thomas, EdD, APRN, PMHCNS-BC, PMHNP-BC, CMP

*University 1-2*

#### **Symposium 7.2**

*Back to the Future: Consultation Skills for the Advanced Practice PMH Nurse*

Peggy Dulaney, MSN, RN

Jim Kane, MS, RN, CNS, NEA-BC

Elizabeth Steinmiller, MSN, PMHCNS-BC

Susan Krupnick, MSN, PMHCNS-BC, ANP-BC, C-PREP

Marilyn Shirk, MN, RN, CNS-BC

Karen Ragaisis, DNP, APRN, PMHNP-BC, PMHCNS-BC, CARN

*University 3-4*

#### **Symposium 7.3**

*Population Health: A Collaborative Evidence-Based Practice Project for Educating Communities on Executive Functions/Functioning Weakness*

Shirlee Cohen, DNP, MPH, ANP-BC, NPP, CCRN

3:30 p.m.-6:30 p.m.

### **Workshop 7**

*Chesapeake*

#### **Workshop 7.4**

*Healing Touch, Experiential Holistic Integrative Therapy for Mental Health*

Linda Volness, MS, APRN, CHTP

*Grand Ballroom DEF*

#### **Workshop 7.5**

*An Effective and Innovative Body-Centered Technique to Locate and Regenerate Painful Emotion and Memories*

Deborah Sandella, PhD, MS, RN

7:00 p.m.-9:00 p.m.

*Off-site: 655 W. Lombard Street, Baltimore, MD 21201*

### **University of Maryland School of Nursing**

*Reception and Tour of Simulation Labs and Nursing Museum*

*(Advance registration required; meet in hotel lobby)*

# SATURDAY

## Program Schedule / March 11

7:00 a.m.-8:00 a.m.

Grand Ballroom

### Breakfast

7:15 a.m.-7:45 a.m.

Grand Ballroom

### Business Meeting

7:45 a.m.-8:30 a.m.

Grand Ballroom

### Awards Ceremony

8:30 a.m.-9:00 a.m.

Grand Ballroom

### President's Wrap-Up

9:15 a.m.-10:05 a.m.

### Workshop 8

University 1-2

#### Workshop 8.1

*Establishing Fidelity of the Positive Thinking Training Intervention for Autism Caregivers*

Abir Bekhet, PhD, RN, HSMI

*Positive Thinking Training Intervention for Caregivers of Persons With Autism Spectrum Disorders: Is There a Need?*

Abir Bekhet, PhD, RN, HSMI

University 3-4

#### Workshop 8.2

*Toolkits and Simulation Using Standardized Patients to Teach*

Debra Webster, EdD, RNBC, CNE

Judith Jaronskinski, PhD, RN

*Use of Standardized Patients in a Psychiatric Mental Health Concepts Course for Nurse Practitioner Students:*

*An Innovative Pedagogic Strategy*

Gail Williams, PhD, PMHCNS-BC

Mark Soucy, PhD, RN, PMHNP, PMHCNS, FAANP

Promenade

#### Workshop 8.3

*Lewy Bodies Dementia: A Case Study of Diagnosis, Treatment, and the Challenges of Care Coordination*

Catherine Kane, PhD, RN, FAAN

Chesapeake

#### Workshop 8.4

*Building Bridges: An Outpatient Mental Health Service for Muslims: Integrating Spiritual, Religious, and Cultural Beliefs and Values*

Marie Rose Bhuiyan, RN, MS, PMHNP-BC

*Association Between COMT (Val158Met) Genotype and Internet Addiction Among College Students in Korea*

Jeehae Chung, PhD(c), RN

Grand Ballroom DEF

### Workshop 8.5

*When Worlds Collide: The Utility of the Psychiatric/Medical-Surgical Dual Specialty*

Kristen Keller, DNP, ACNP-BC, PMHNP Student

*Development of an Interprofessional, Collaborative*

*Academic Partnership to Foster Student Growth and Enhance*

*Application of Evidence Based Practice*

Katherine Riedford, PhD, PMHNP-BC, RN

10:05 a.m.-10:20 a.m.

Grand Ballroom Foyer

### Refreshment Break

10:20 a.m.-11:10 a.m.

### Concurrent Session 9

University 1-2

#### Concurrent Session 9.1

*Competency Narratives: Differentiating and Strengthening Professional Identities and Roles*

Karen Kverno, PhD, PMHCNS-BC, PMHNP-BC

Julia Knauff, DP, RN, FNP-BC

*Improving Access to Rural Mental Health Care:*

*Development of a Dual-Specialty PMHNP-FNP Program*

Rene Love, PHD, DNP, PMHNP

Kate Shepard, PhD, RN, FNP, PMHNP-BC, FAANP

University 3-4

#### Concurrent Session 9.2

*East Meets West in Psychiatry: Yoga as an Adjunct Therapy to Psychotropic Medication*

Nadia Bukar, BSN, RNC

*Utilizing Yoga and an Interdisciplinary Approach to Connect With At-Risk Female Adolescents*

Andrea Kwasky, DNP, PMHNP-BC, PMHCNS-BC

Mary Serowoky, DNP, FNP-BC

Promenade

#### Concurrent Session 9.3

*Building a Program of Research: From Idea to Reality (and Everything in Between)!*

Jill Bormann, PhD, RN, FAAN

Chesapeake

#### Concurrent Session 9.4

*Addressing Emotional Health and Self-Care to Promote Diabetes Prevention: Lessons Learned From a RCT on Mindfulness-Based Stress Reduction in African American Adults With Pre-Diabetes*

Cheryl Giscombe, PhD, RN, PMHNP-BC

Grand Ballroom DEF

#### Concurrent Session 9.5

*What Is the Best Practice: The Therapeutic Relationship and Motivational Interviewing for Psychiatric Nurses*

Barbara Buxton, PhD, PMHCNS-BC, MSN, BSN

Todd Hastings, PhD, RN



11:25 a.m.-12:25 p.m.

Grand Ballroom

### Closing Keynote

*Psychiatric Nurses Transforming Health and Health Care*

Diana Mason, PhD, RN, FAAN

*Funding for this presentation is possible, in part, through funds generously donated to the ISPN Foundation.*

12:30 p.m.

**Conference Ends**

12:45 p.m.-5:00 p.m.

Harbor 2

**ISPN Board of Directors Meeting**



## POST-DOCTORAL PSYCHIATRIC MENTAL HEALTH NURSE PRACTITIONER CERTIFICATE



UNIVERSITY  
of MARYLAND  
SCHOOL OF NURSING



Learn an integrated approach to addressing the needs of **BODY, MIND, SOUL, and SPIRIT** in this certificate program designed for nurses who are already prepared at the doctoral level in another specialty.

This 2 ½ year program prepares you to:

- take the American Nurses Credentialing Center's Psychiatric-Mental Health Nurse Practitioner (across the lifespan) certification exam
- meet the growing demand for qualified psychiatric mental health nurse practitioners
- educate nursing students across all education levels in psychiatric mental health nursing.

***Learn more: [nursing.umaryland.edu/psychcertificate](http://nursing.umaryland.edu/psychcertificate)***

# POSTER SESSIONS

## Stadium Ballroom

### Setup

5:00 p.m.-6:15 p.m.

Wednesday, March 8

### Display

6:30 p.m.-8:00 p.m.

Wednesday, March 8  
(Opening Reception)

7:30 a.m.-5:00 p.m.

Thursday, March 9

7:00 a.m.-3:30 p.m.

Friday, March 10

### Teardown

3:30 p.m.-4:30 p.m.

Friday, March 10

**1** Psychiatric Medication Inpatient Education Using Teach Back Methodology  
*Diane Oran, MN, RN, CNS/NP-BC*

**2** Changes in the Willingness of a Schizophrenic Patient Participating in Therapeutic Recreation to Interact With Others—Analysis Using the Theory of Symbolic Interactionism  
*Ayumi Kohno, RN, PhD*

**3** Acting with a Purpose: The Lived Experience of Actors in the Role of Standardized Patients Portraying Mental Illness  
*Judith Jaronsinski, PhD, RN*

**4** Examining Nursing Students' Attitudes Toward People With Mental Illness  
*Todd Hastings, PhD, RN*

**6** Factors Influencing the Awareness of Medication Adherence Among Inpatients With Schizophrenia in Acute Psychiatric Units in Japan: A Basic Study With a Focus on Patients' Participation in Psychoeducation  
*Mitsunobu Matsuda, RN, PhD*

**7** The Posttraumatic Stress Disorder (PTSD) Recovery Model: Deconstructing Trauma Narratives to Identify the Basic Psychosocial Process of PTSD Recovery  
*Pamela Phillips, PhD, RN*

**8** Introduction and Use of Drum Therapy in a Mental Health Secure Extended Care Unit (SECU)  
*Breanna Achterbosch, RN, PGDip, Mental Health Nursing*

**9** Assessment: How To Make Your Student's Electronic Gadget a Fun In-Class Evaluation Tool  
*Caroline Moriarity, DPM, MSN, APRN, PMHRN-BC*

**11** The Lifestyle Choices and Health Outcomes of Aging Parents of Adult Children With ID/DD  
*Karen Pounds, PhD, PMHCNS, BC*

**12** An Action Plan for Educators: Training Future PMHNPs in Cognitive Behavioral Therapy  
*Erin Ellington, DNP, RN, PMHNP-BC*

**13** Effectiveness of Substance Abuse and Brief Intervention Training on APRN Students  
*Caroline McKinnon, PhD, PMHCNS-BC*

**14** Contributing Factors on Benefit Finding Among People with Chronic Mental Illness: Findings From a Longitudinal Study in Japan  
*Rie Chiba, PhD, RN, PHN*

**15** Screening for Substance Abuse Using an Evidence-Based Model: SBIRT Training for Nursing and Social Work Students  
*Suzanne Billingsly, DNP, RN, PMHCNS*

**16** Nursing Students' Feelings About Mental Health Nursing: Concept, Coursework, Career  
*Todd Hastings, PhD, RN*

**19** Prescribed Exercise for the Treatment of Depression in a College Population: An Interprofessional Approach  
*Brittany Yates, DNP, APRN, PMHNP-BC*

**20** BSN Student Responses to a "Hearing Voices" Audio Simulation: A Content Analysis of Post-Experience Response Papers  
*Vicky Whitehead, RN, MSN*

**22** The Present and Future of Pharmacogenomic Testing in Psychiatry  
*Lisa Gumbs Hanan, RN, FNP, LCSW*

# POSTER SESSIONS

Stadium Ballroom

**24** Military Children's Perceptions of Parents' Frequent Missile Base Deployments  
*Deborah Jones, CPNP, RN*

**25** Addressing Gaps and Challenges in Implementing Alcohol Screening and Brief Intervention (Alcohol SBI) for Psychiatric Nurses: A Focus on Nursing Leaders  
*Khadejah F. Mahmoud, MSN, RN*

**27** Environmental Justice and Healthy Homes for Individuals With Severe and Persistent Psychiatric Illnesses: A Future Role for Mental Health Nursing Practice  
*Katherine Coury, BA, Nursing Student (BSN)*

**28** A Grounded Theory Study of the Process of Prodromal Experiences Prior to the Diagnosis of Schizophrenia  
*Sunny Chieh Cheng, MSN*

**29** Can You Teach an Old Dog New Tricks? A Radical Presence Approach  
*Christine Moriconi, PsyD, LMFT, PMHCNS-BC, RN*

**30** Effect of APN with Dual Adult and Psychiatric Mental Health Certification on Emergency Department Visits by Veteran Domiciliary Residents  
*Ingrid Barcelona, DNP (c), PMC, MSN, PMHNP-BC, ANP-BC*

## Setup

5:00 p.m.-6:15 p.m.

Wednesday, March 8

## Display

6:30 p.m.-8:00 p.m.

Wednesday, March 8  
(Opening Reception)

7:30 a.m.-5:00 p.m.

Thursday, March 9

7:00 a.m.-3:30 p.m.

Friday, March 10

## Teardown

3:30 p.m.-4:30 p.m.

Friday, March 10

Alkermes plc is a fully integrated global biopharmaceutical company that applies its scientific expertise and technological know-how to develop innovative medicines for the treatment of central nervous system (CNS) diseases, including schizophrenia, depression, addiction and multiple sclerosis.

For more information about Alkermes, please visit:

[www.alkermes.com](http://www.alkermes.com)

**Alkermes**  
Patient inspired

# SAFETY RULES & GUIDELINES

We welcome you to the 2017 ISPN Annual Conference. We know that you will find this to be an enriching and fulfilling experience. To ensure the safety and security of our attendees and guests, we have compiled the following list of safety rules and guidelines for this conference.

Baltimore Marriott Inner Harbor at Camden Yards is committed to providing our guests a safe and secure stay. When a security or safety situation arises, or an incident occurs that should be brought to our attention, we ask that you observe the following reporting protocols:

- **For emergency aid of any kind, call 911** from any telephone outside of the hotel grounds.
- Review the fire safety procedures located on the door in your hotel room. Note the location of the fire exits in relation to your hotel room.
- Don't answer the door in your hotel room without verifying who it is. All hotel employees will identify themselves verbally and will have a silver nametag. Please call the front desk or the operator if you are uncomfortable or uncertain.
- When returning to the hotel late in the evening, use the lobby entrance.
- Close the door securely whenever you are in your hotel room and use all of the locking devices provided.
- Secure all your valuables. Safe deposit boxes are available at the Front Desk.
- Do not leave any articles of value in your vehicle in the parking lot.

When inside the conference venue, nametags should always be worn and visibly displayed. For security reasons, we recommend that you **DO NOT** wear your badge outside of the Baltimore Marriott Inner Harbor at Camden Yards.

Please do not leave any bags, laptops or articles unsecured in any display area, meeting room, or public area. Personal items are most commonly left or lost in the restrooms. Please double-check the area before leaving the restrooms.

Smoking is not permitted in the hotel. It is considered a smoke-free environment.

Do not open any fire exit or other access door to any person. Access to the conference is strictly for members and registered conference guests. All access to display areas, meetings, and symposia is through the appropriate entrance doors. All fire exits are alarmed.

If you note any suspicious article, packages, persons, or activity please contact the event staff or the front desk immediately.

Do not give your lodging information to any person.

In the event of an alarm, follow the following directions:

- Proceed carefully to the nearest exit. Emergency evacuation routes are located on the back of every guestroom door. All public space areas are clearly marked with Exit signs.
- Use the stairwells to evacuate the building. Do not attempt to use the elevators.
- Any guest requiring assistance during an evacuation should dial "0" and notify the operator of their location.

During an alarm, announcements will be made over the PA system informing guests to evacuate. For further information, read the security section of your in-room guest directory.



**Our work  
is focused  
on the  
central  
nervous  
system.**

*But it comes  
from the heart.*



©2017 ACADIA Pharmaceuticals Inc.  
All rights reserved. ACAD-0035 02/17.

[www.acadia-pharm.com](http://www.acadia-pharm.com)



ISPN would like to thank  
its 2017 Annual Conference Sponsors!



**Frontier Nursing University**

**Global Alliance for Behavioral Health & Social Justice**

**MHM Services Inc.**

**University of Maryland School of Nursing**

# HOTEL FLOOR PLANS

## Baltimore Marriott Inner Harbor at Camden Yards—First Floor

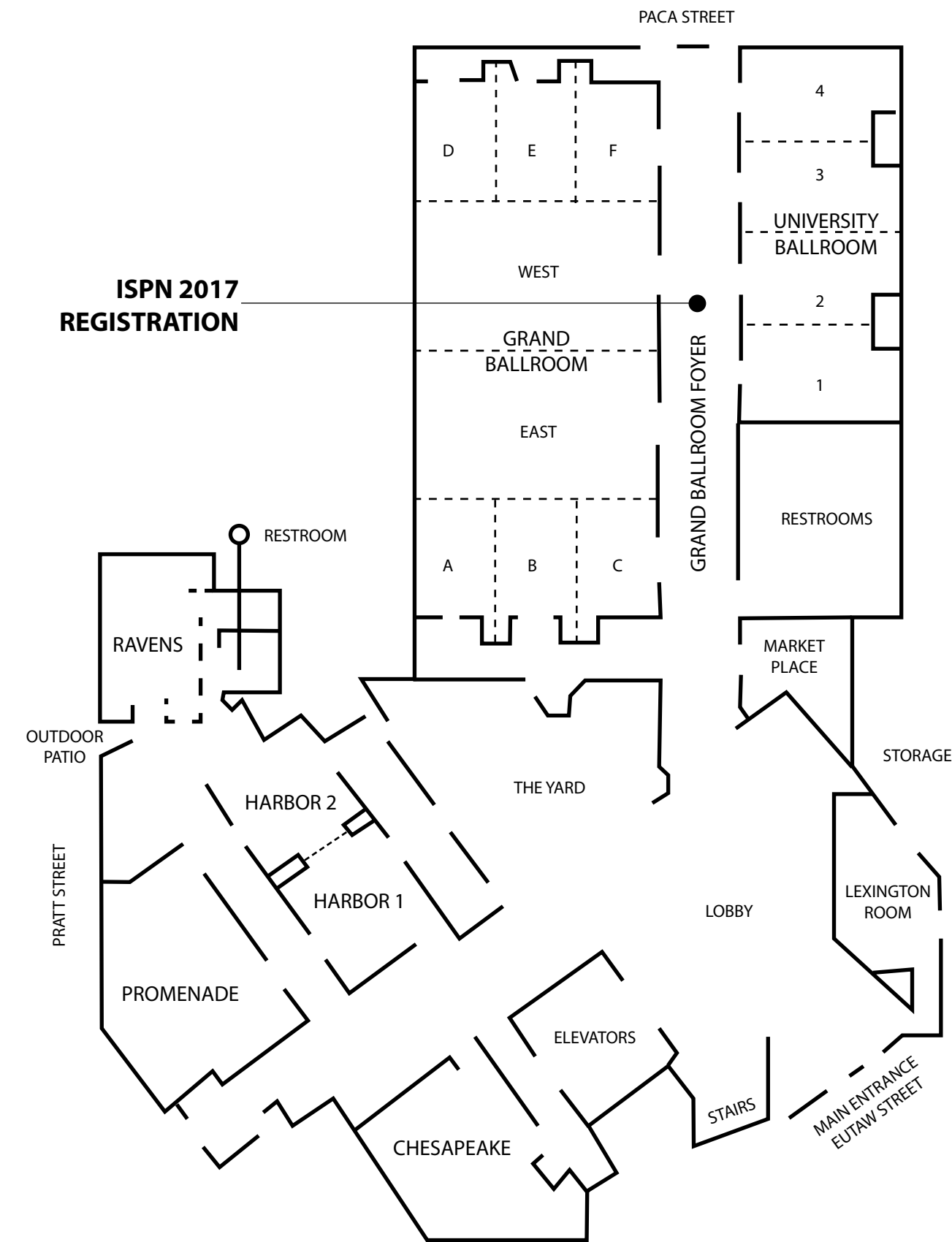

# HOTEL FLOOR PLANS

## Baltimore Marriott Inner Harbor at Camden Yards—Second Floor

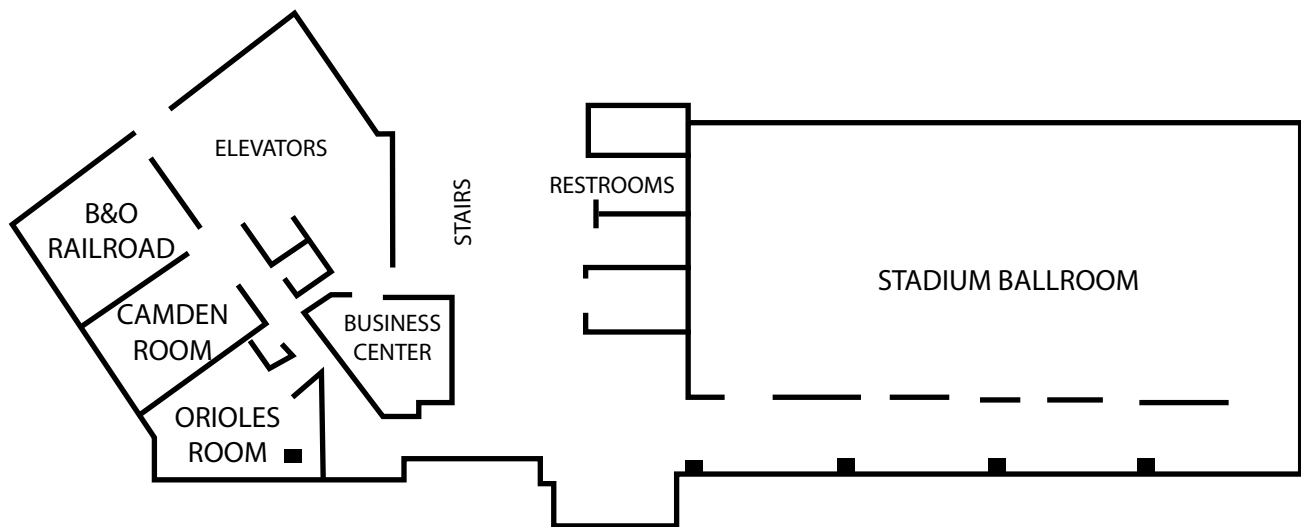

*When your commitment  
to wellness grows...*



FRONTIER NURSING  
UNIVERSITY®

# Answer the call.

Add a Psychiatric-Mental Health Nurse Practitioner Specialty Today!



FNU's new PMHNP program is for currently certified Nurse-Midwives and Nurse Practitioners who would like to add a specialty in psychiatric-mental health:

- Earn a Post-Master's Certificate with option of completing a Companion DNP.
- Complete coursework online with clinicals in your home community.
- Two brief visits to Hyden, Kentucky campus (4 days and 5 days).
- MSN + Companion DNP option coming soon

Seeking New Psych-Mental Health Faculty  
and Preceptors Nationwide!

Students, Prospective Faculty and Preceptors  
Learn More at [Frontier.edu/ISPN](http://Frontier.edu/ISPN)



# Want to Know the Best Kept Secret in Mental Health?

Correctional Mental Health with MHM Services!

**Psychiatric Nurse Practitioners throughout the US are discovering the unique advantages of a career in correctional mental health with MHM Services, a leader in this progressive field.**

**Excellent Full Time, Part Time, & Per Diem Psychiatric Nurse Practitioner opportunities throughout the United States**

For more information, please contact:

**Jane Dierberger**

**414.930.1830 or email at [Jane@mhmcareers.com](mailto:Jane@mhmcareers.com)**



**MHM Services, Inc**

[www.mhm-services.com](http://www.mhm-services.com) | Equal Opportunity Employer



**TEMPE**  
ARIZONA

**Save the Date**

**ISPN2018**  
April 10-14

Tempe Mission Palms